

Donation Method

I would like to make my donation in the following way (please tick the appropriate box):

- A single donation of £100 (enclosed)
- A donation of £25 (enclosed) and three further donations of £25 monthly thereafter.
- A single donation of £125 (enclosed)
- A donation of £35 (enclosed) and three further donations of £30 monthly thereafter.

(Please use provided envelope for enclosing donations. Please make cheques payable to St Joseph's Church.)

Name:

Address:

Postcode: Telephone:

eMail:

Signature: Date:

GIFT AID DECLARATION

If you are a UK Taxpayer, you can add 25p to every £1 that you donate at no extra cost to yourself with Gift Aid. If you can help in this way, please tick the box below.

I am a UK taxpayer and I would like the parish of Our Lady of the Immaculate Conception & St Joseph, Waltham Cross to treat all donations that I make (from the date above) as Gift Aid donations until I notify you otherwise. My annual income tax and/or capital gains tax will be more than the tax that the parish will reclaim.

This declaration must be in one name only.

For official use only

PARISH

New Parish Centre Waltham Cross

+WALT

Westminster Roman Catholic Diocese Trust. Charity No. 233699

Donate a Brick
and
Become a Part of History



Our Lady of the Immaculate Conception
and St Joseph

A NEW PARISH CENTRE

The vision of a new parish centre was born from a need to not only replace the two deteriorating existing parish halls adjacent to St Joseph's Church, but a desire to meet the needs of our changing surrounding community.

The new parish centre, with its meeting rooms, parish office, toilets, kitchen and dual purpose hall area, will provide brand new facilities in an energy efficient building at the heart of the St Joseph's parish for generations to come.

This is an exciting project which proclaims that the Roman Catholic Church is very much alive and continues to be at the heart of many local activities. It is estimated it will cost circa £1,000,000 to build the new parish centre and as a part of the many fundraising activities to help finance the project, we hope you will feel encouraged to become part of this vision by Donating A Brick.

Made from high quality materials your brick will be individually engraved and hand painted. These bricks will become a legacy that will last for many years and will be a historic way to remember your family connection and your personal bond with St Joseph's wherever you may be in the world in the future.

The intention is to create two areas where you will be able to donate a brick. One area will be an outside Walkway of Support with Brick Pavers, whilst the other area will be inside the new centre entrance on the Donation Wall with Brick Wall Slips.

A copy of this form will kept by the parish office as a central record. Please copy this form for your own reference.

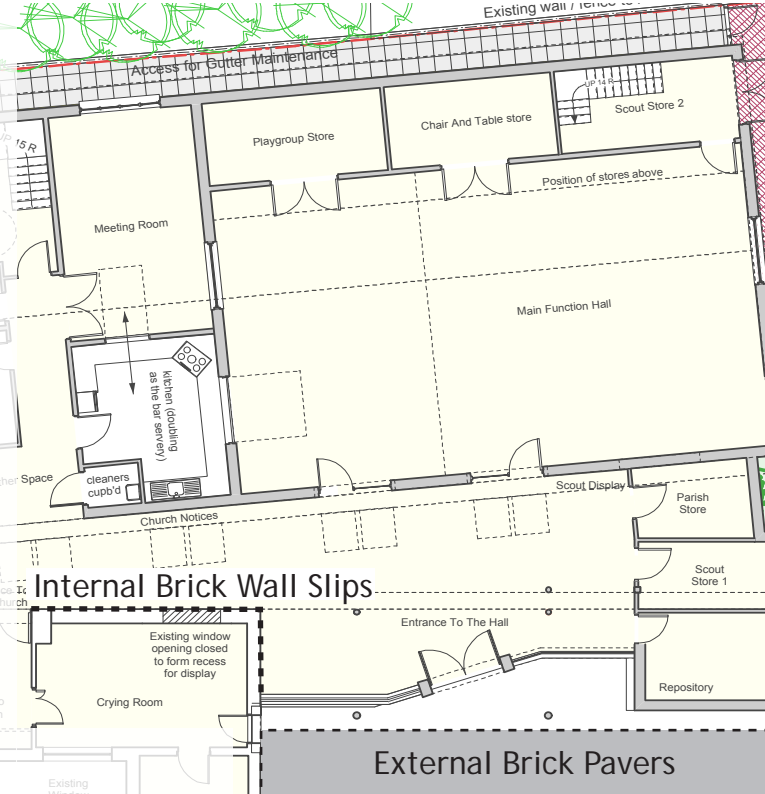

THE BRICKS

OPTION 1: Internal Brick Wall Slips



PRICE: £125

OPTION 2: External Brick Pavers



PRICE: £100

DONATION FORM

Please select a brick type: External Brick Paver £100 Internal Brick Wall Slip £125

Please enter IN BLOCK CAPITALS and in black ink, the characters you would like inscribed on your Brick Type - You may have a maximum of 16 characters per line, but remember that spaces and punctuation marks also count as characters.

Example 1:

B	O	Y	S	N	A	M	E										
P	U	P	I	L	1	9	8	7	-	2	0	0	2				

Example 2:

I	N	M	E	M	O	R	Y	O	F								
J	A	M	E	S	A	N	O	T	H	E	R						

Brick to be engraved: